

# The US Science Pavilion

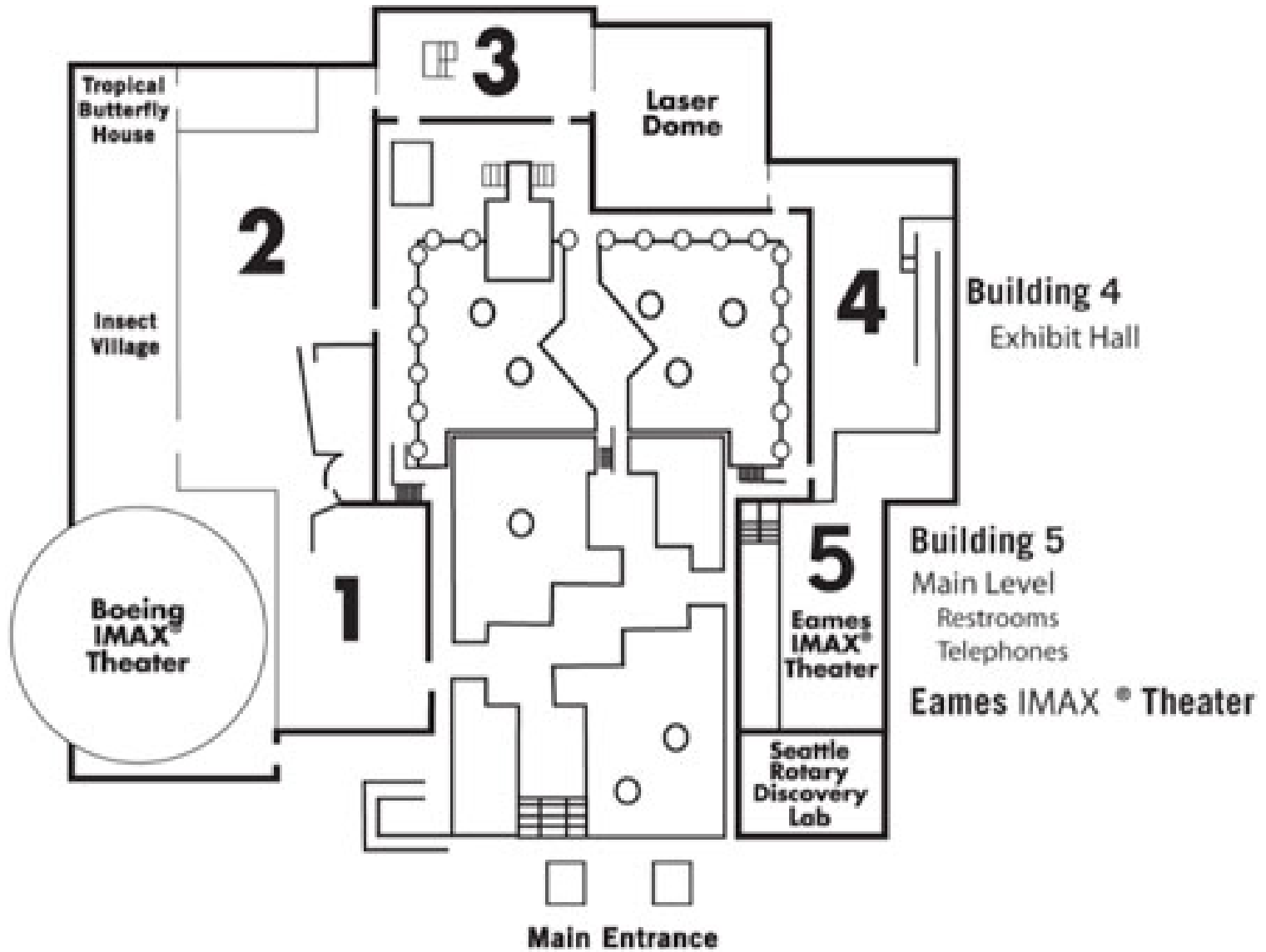

OF THE SEATTLE WORLD'S FAIR  
1962

FROM THE RECORDS OF THE  
NATIONAL ARCHIVES AND RECORDS ADMINISTRATION,  
SEATTLE, WASHINGTON



**The Science Center Today (2011)**

**Model of Science Pavilion (Now the Science Center) created before construction**

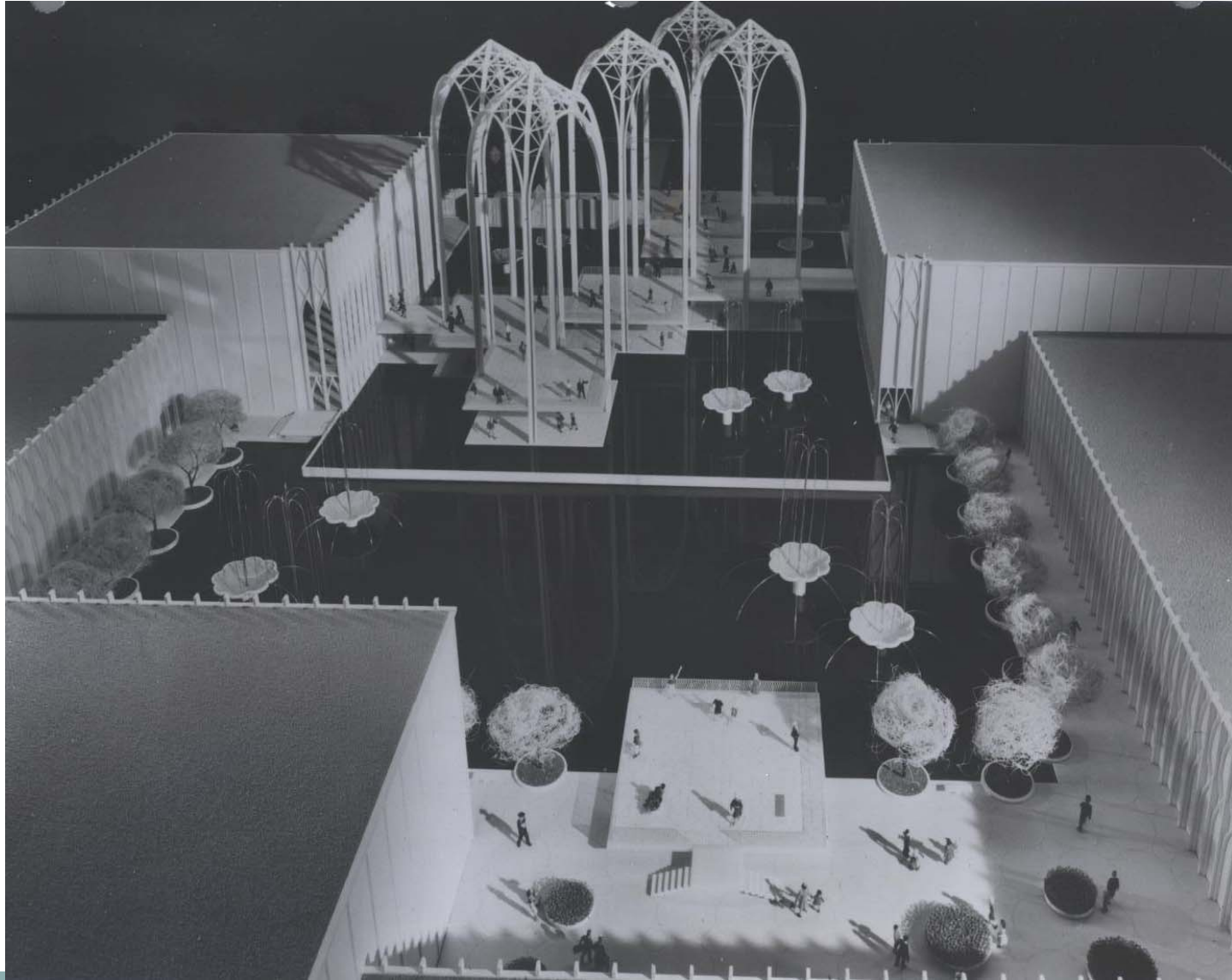

# Guidebook page of the US Science Pavilion during the Seattle World's Fair in 1962

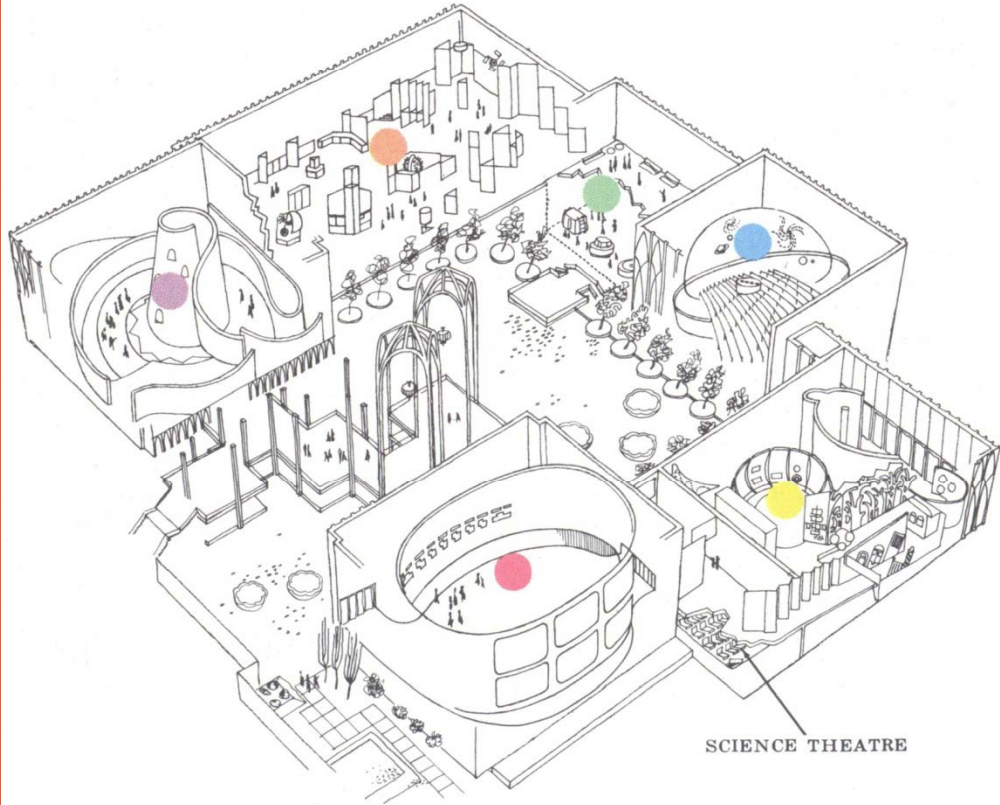
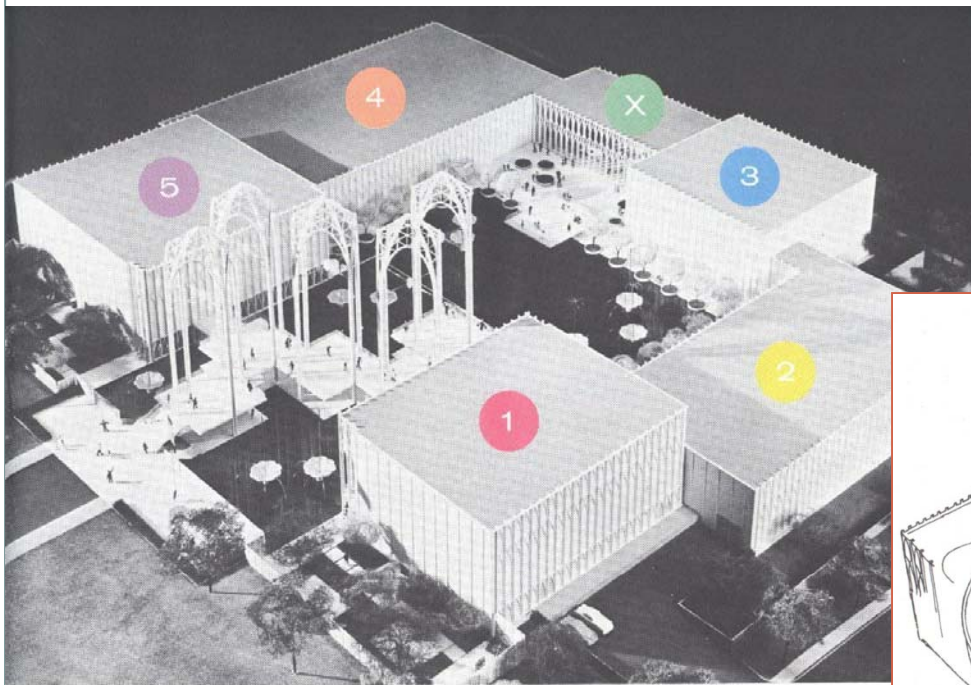

## GUIDE TO THE UNITED STATES SCIENCE EXHIBIT

Colored numbers indicate the preferred sequence in which the exhibits should be seen and are keyed to corresponding sections of this book. The Junior Laboratory of Science is for children from eight to sixteen years of age.

- 1 *The House of Science*
- 2 *The Development of Science*
- 3 *U.S.-Boeing Spacearium*
- X *Junior Laboratory of Science*
- 4 *The Methods of Science*
- 5 *The Horizons of Science*

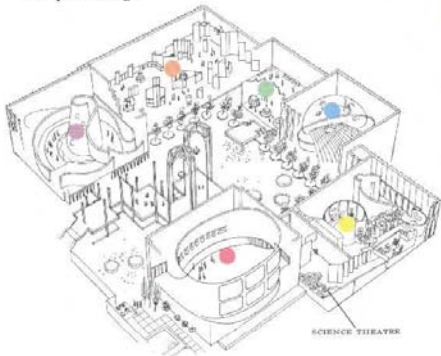

SCIENCE THEATRE

# Area 1 – The House of Science

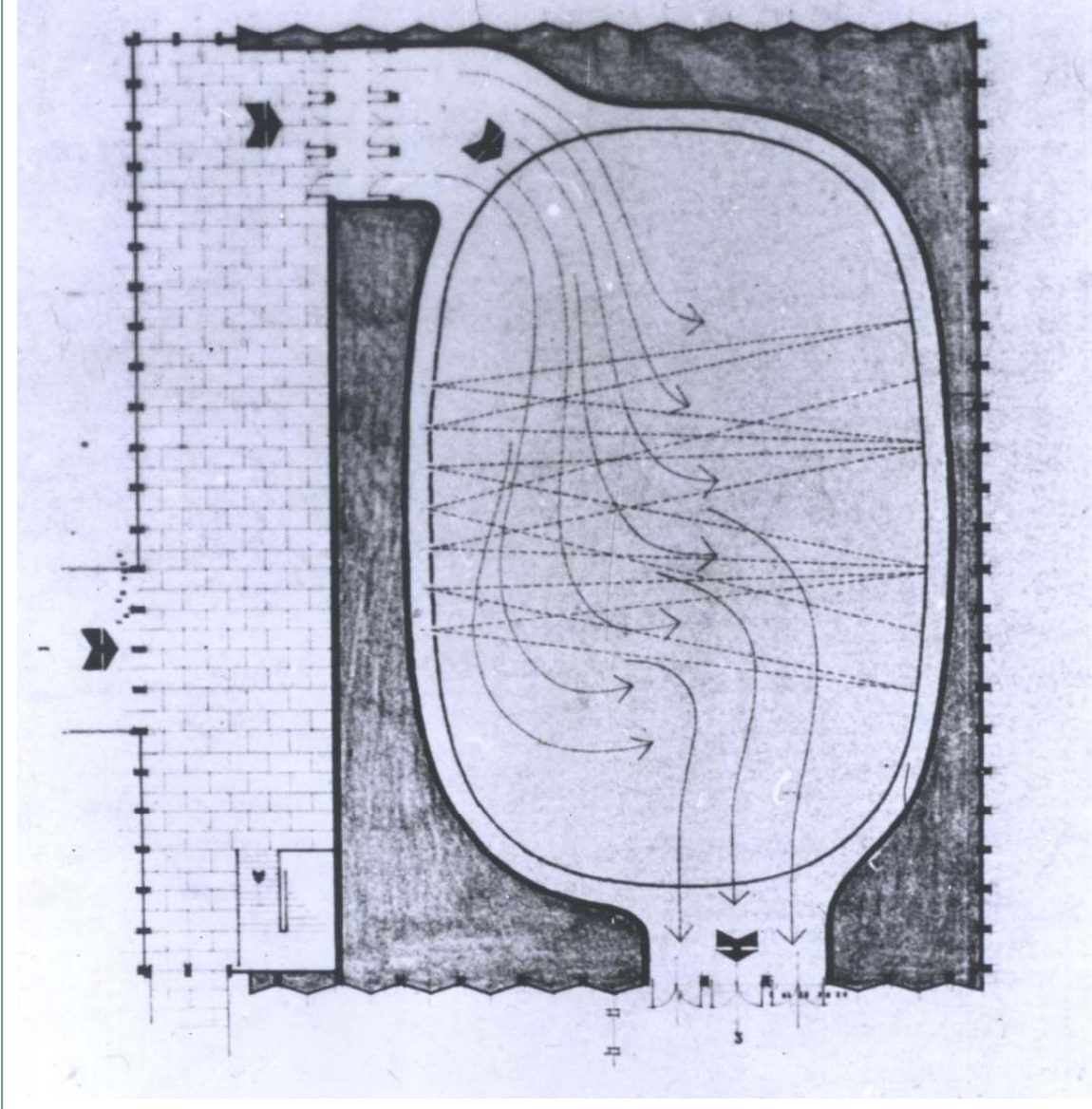

“House of Science”  
flow chart and floor  
plan showing

- 1) the flow of the audience and
- 2) the positions of the projection cameras

# Area 1 – The House of Science



# Area 1 – The House of Science



# Area 1 – The House of Science





# Area 1 – The House of Science

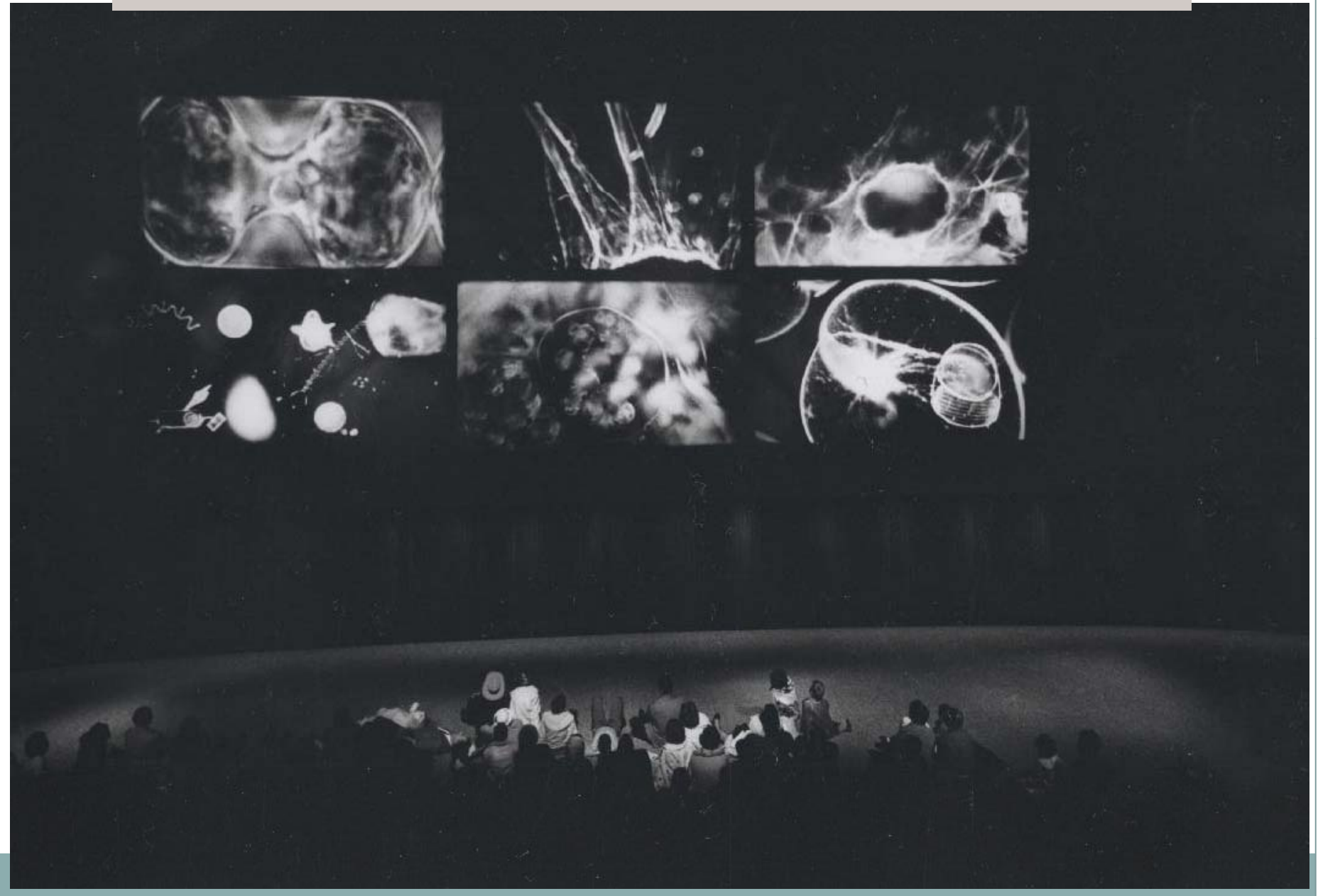

# Area 1 – The House of Science

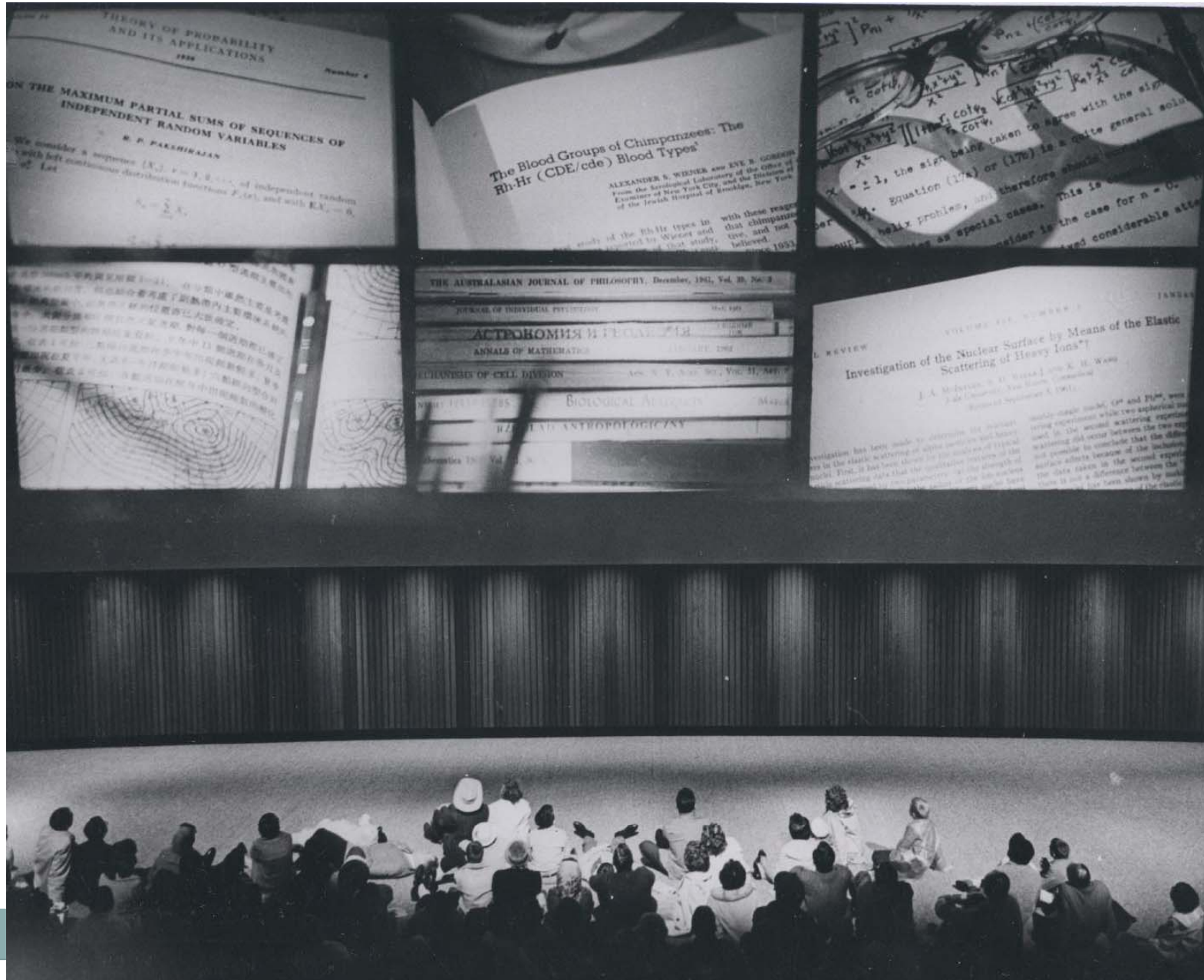

# Science Theater



# Science Theater



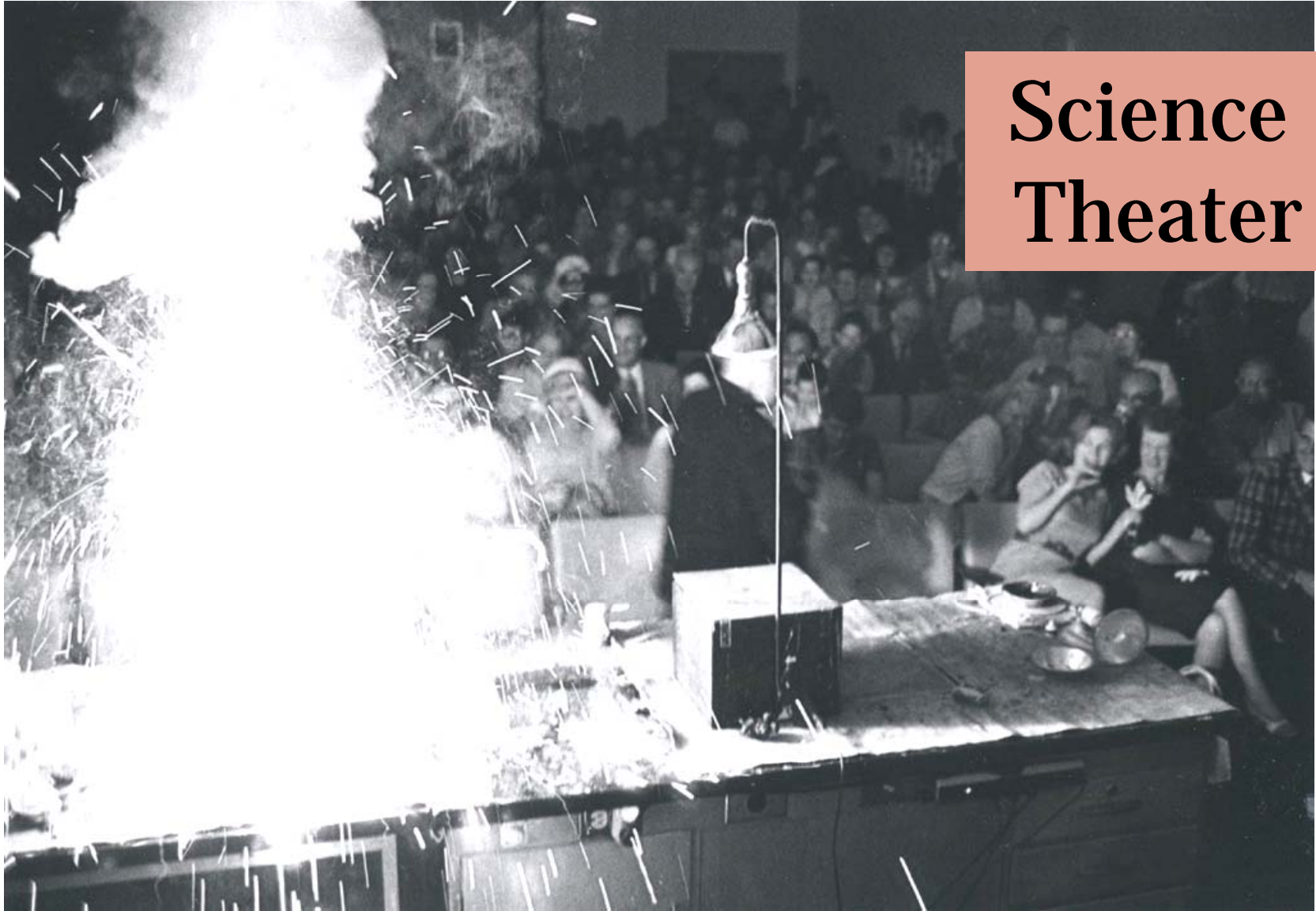

# Science Theater

# Science Theater





# Science Theater

## Area 2 – The Development of Science





# Area 2 – The Development of Science



## Area 2 – The Development of Science





## Area 2 – The Development of Science

## Area 2 – The Development of Science

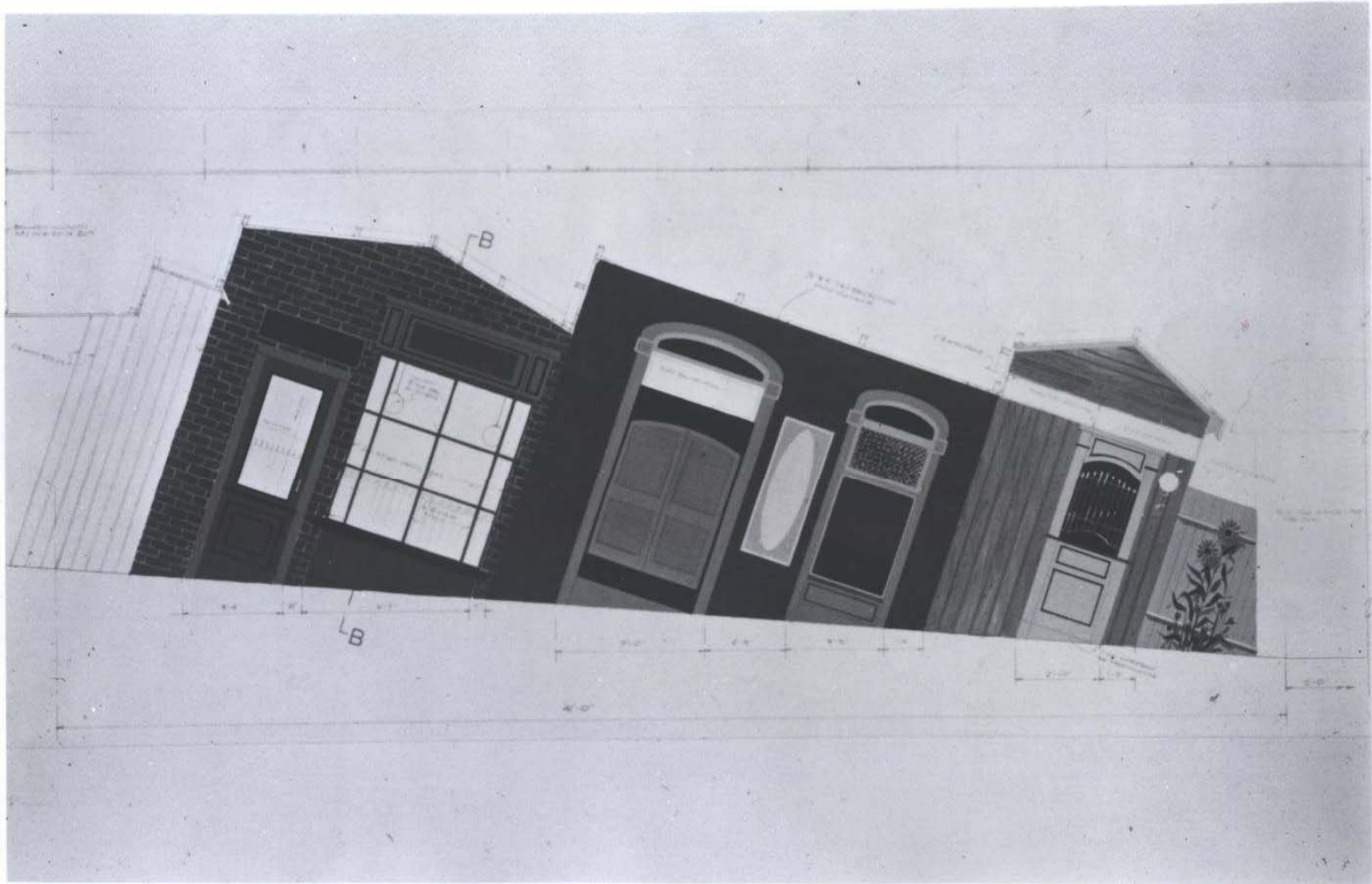

## Area 2 – The Development of Science



## Area 2 – The Development of Science



Darwin's Forest

# Area 3 – Boeing Spacearium

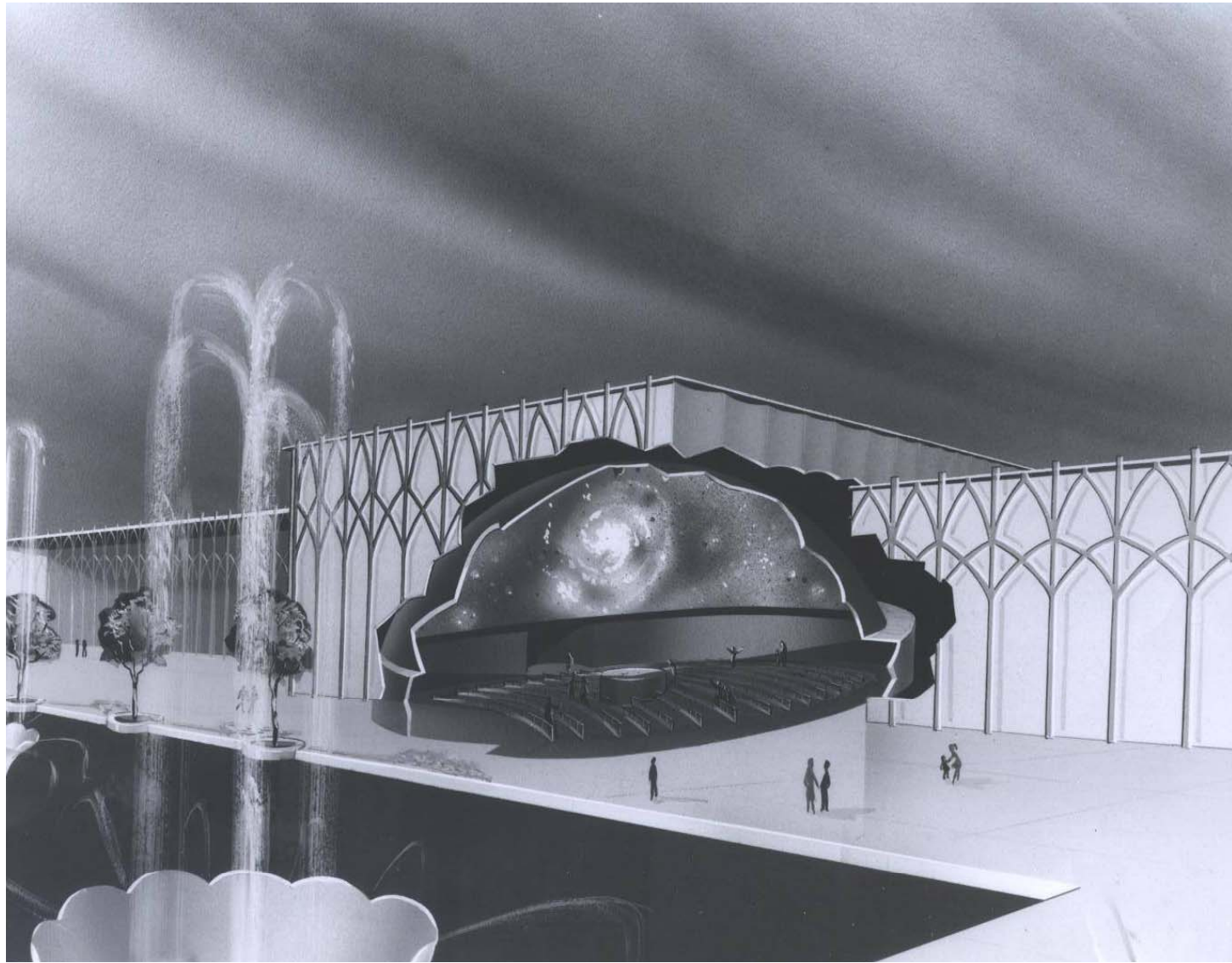



# Area 3 Boeing Spacearium



# Area 3 Boeing Spacearium

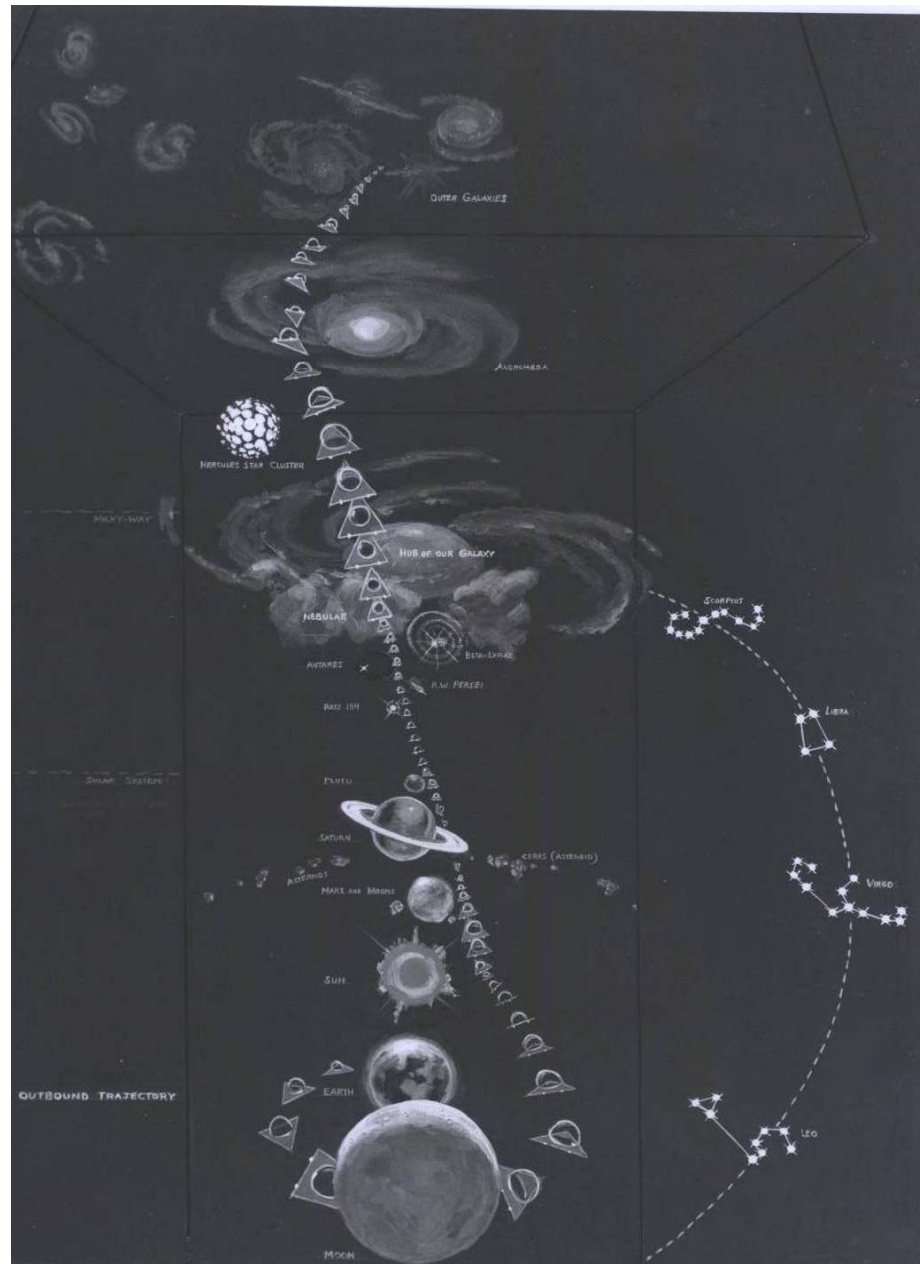







**Area 3  
Boeing  
Spacearium**





# Junior Laboratory of Science



## 12. REFLECTING TELESCOPE

Light from distant stars  is very, very dim. We use big mirrors  in reflecting telescopes  to catch enough starlight so we can see  and photograph  the stars .

The mirror in this telescope is 16 inches across  but the largest, on Mt. Palomar, is almost 17 feet in diameter .

With it, astronomers can find stars  over one billion light-years away (or 6,000 million million million miles).

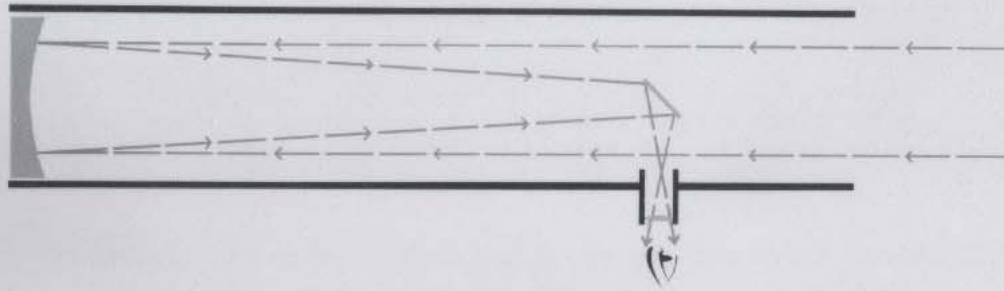

**Junior  
Laboratory of  
Science**

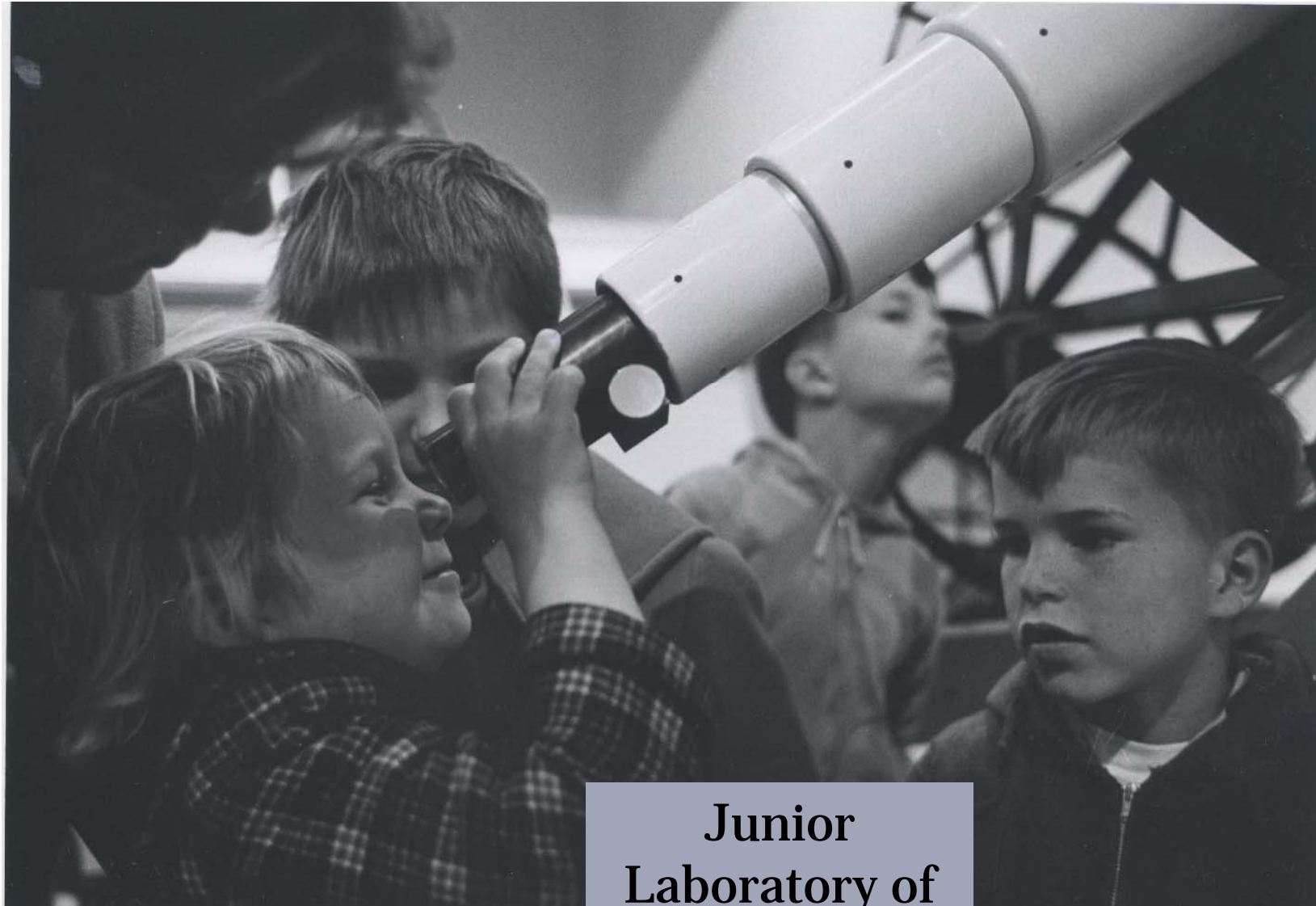

**Junior  
Laboratory of  
Science**



**Junior  
Laboratory of  
Science**

# THE SPEECH STOPPER



## Junior Laboratory of Science



**Junior  
Laboratory of  
Science**





**Junior  
Laboratory of  
Science**

## Junior Laboratory of Science





**Junior  
Laboratory of  
Science**

## Junior Laboratory of Science





## Area 4

# The METHODS of Science

# Area 4

## The METHODS of Science



# Area 4

## The METHODS of Science



# Area 4

## The METHODS of Science





# Area 4

## The METHODS of Science



# Area 4

## The METHODS of Science



# Area 4

## The METHODS of Science



# Area 4

## The METHODS of Science



EXPLORING DOWNWARD is depicted in the Mohole Exhibit in Building IV of the U. S. Science Exhibit at the Seattle World's Fair. The exhibit deals with an experiment conducted off the Southern California coast when a hole was drilled (using a ship-mounted drilling platform) through the thin crust of the earth in an effort to gain some knowledge of this planet's interior. The display is but one of more than 125 exhibits dotting the six buildings of the Federal Pavilion.

# Area 5

## The Horizons of Science

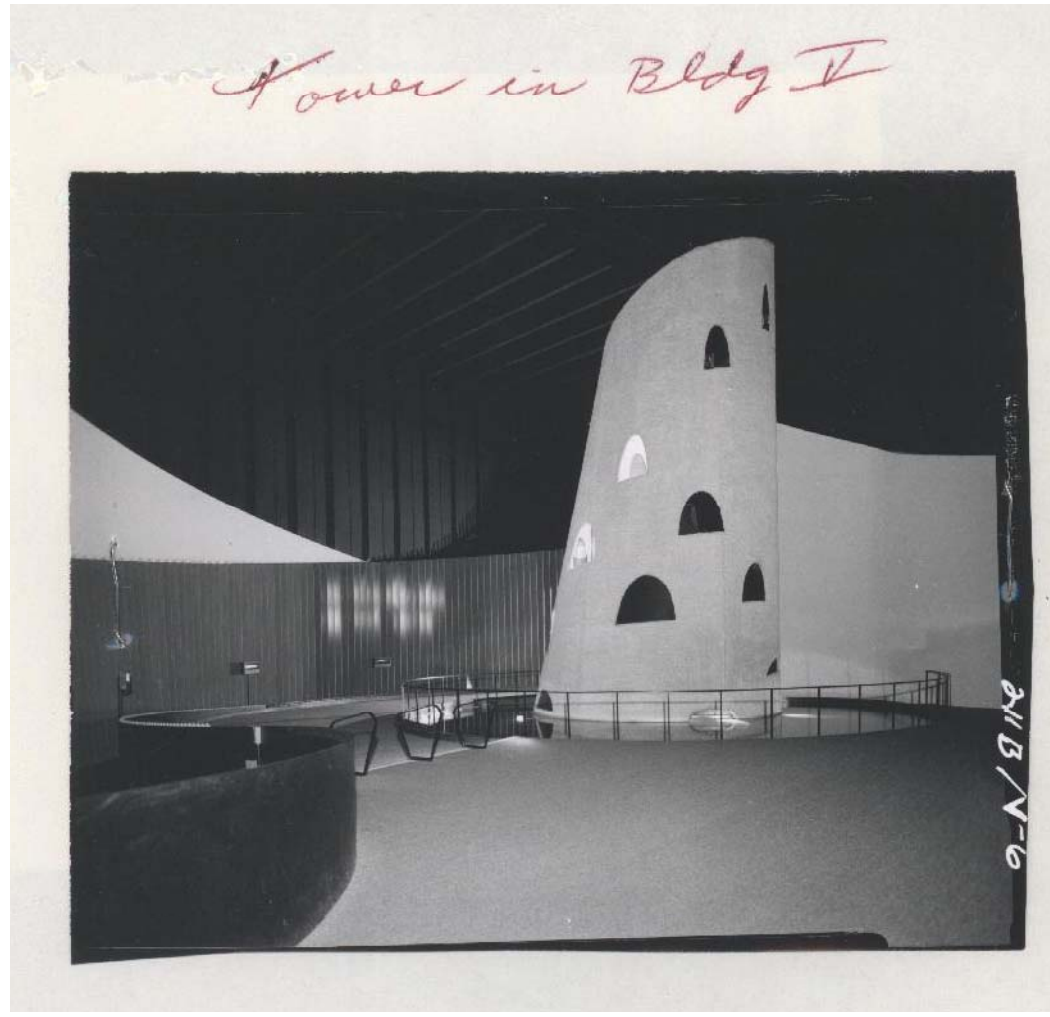

# Area 5

## The Horizons of Science

*Wall in Bldg. V*



# Area 5

## The Horizons of Science



# Area 5

## The Horizons of Science

#3 - Low Friction Carts

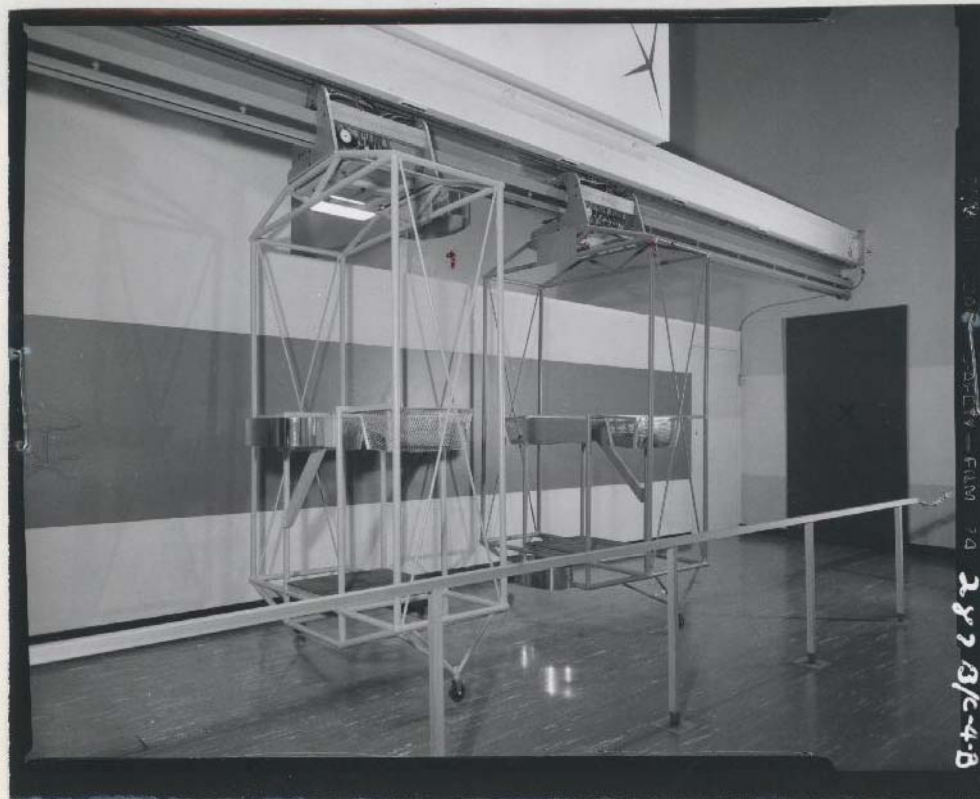



# Area 5

## The Horizons of Science



# Area 5

## The Horizons of Science

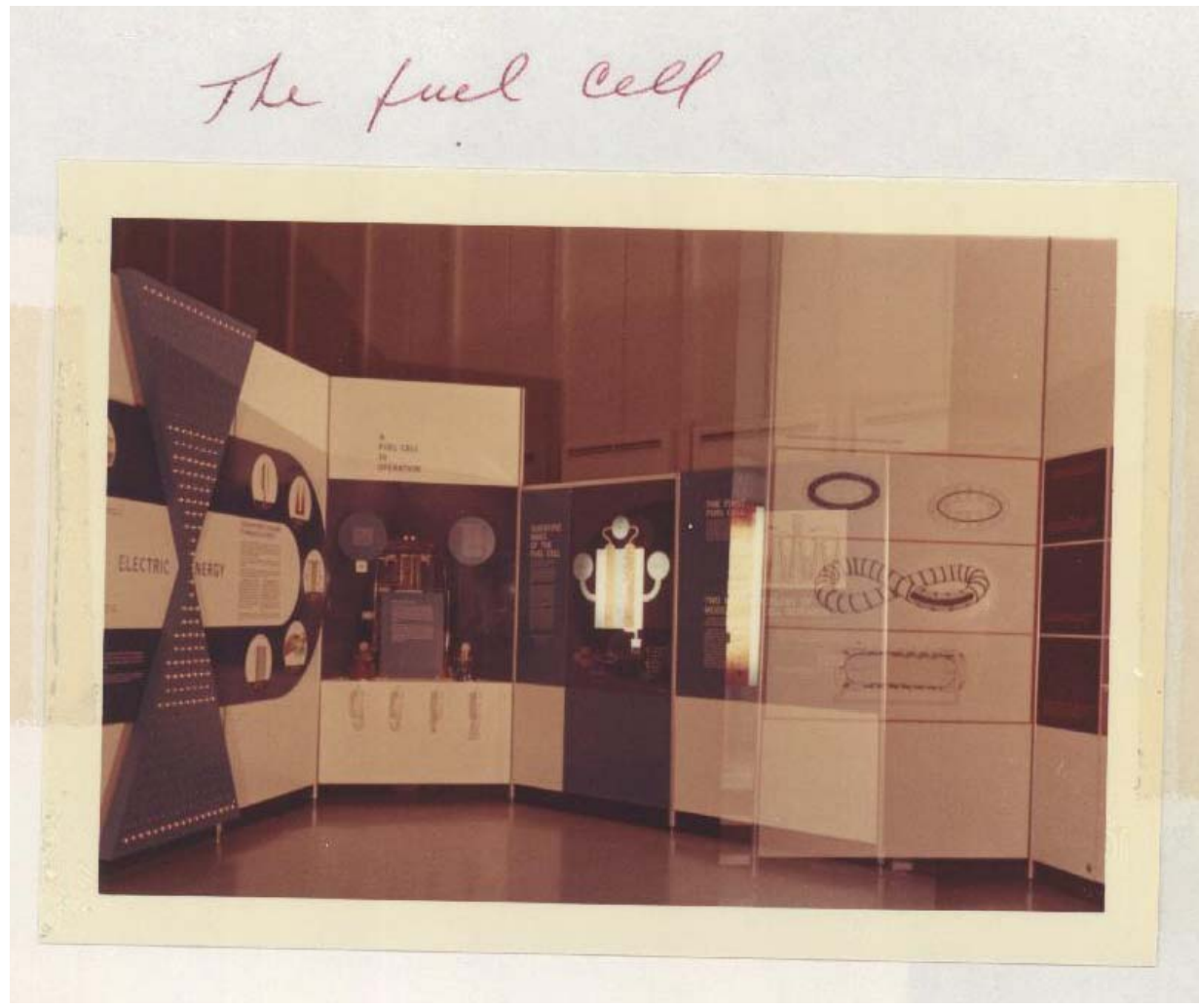

# Area 5

## The Horizons of Science





6125 Sand Point Way NE  
Seattle, WA 98115  
206-336-5115

[seattle.archives@nara.gov](mailto:seattle.archives@nara.gov)